

GROUND FLOOR PLAN
SCALE = 1:100

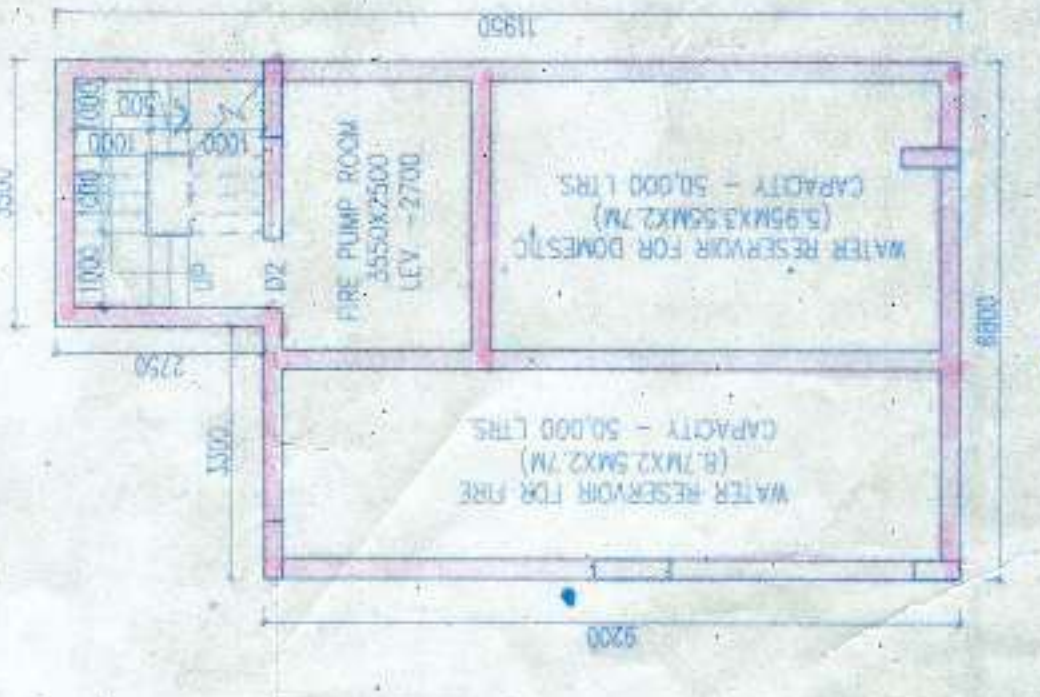

EXISTING BUILDING PLAN
SCALE = 1:200



DETAIL OF UNDER-GROUND RESERVOIR & PUMP ROOM
SCALE = 1:100



LOCATION PLAN
SCALE = 1:5000

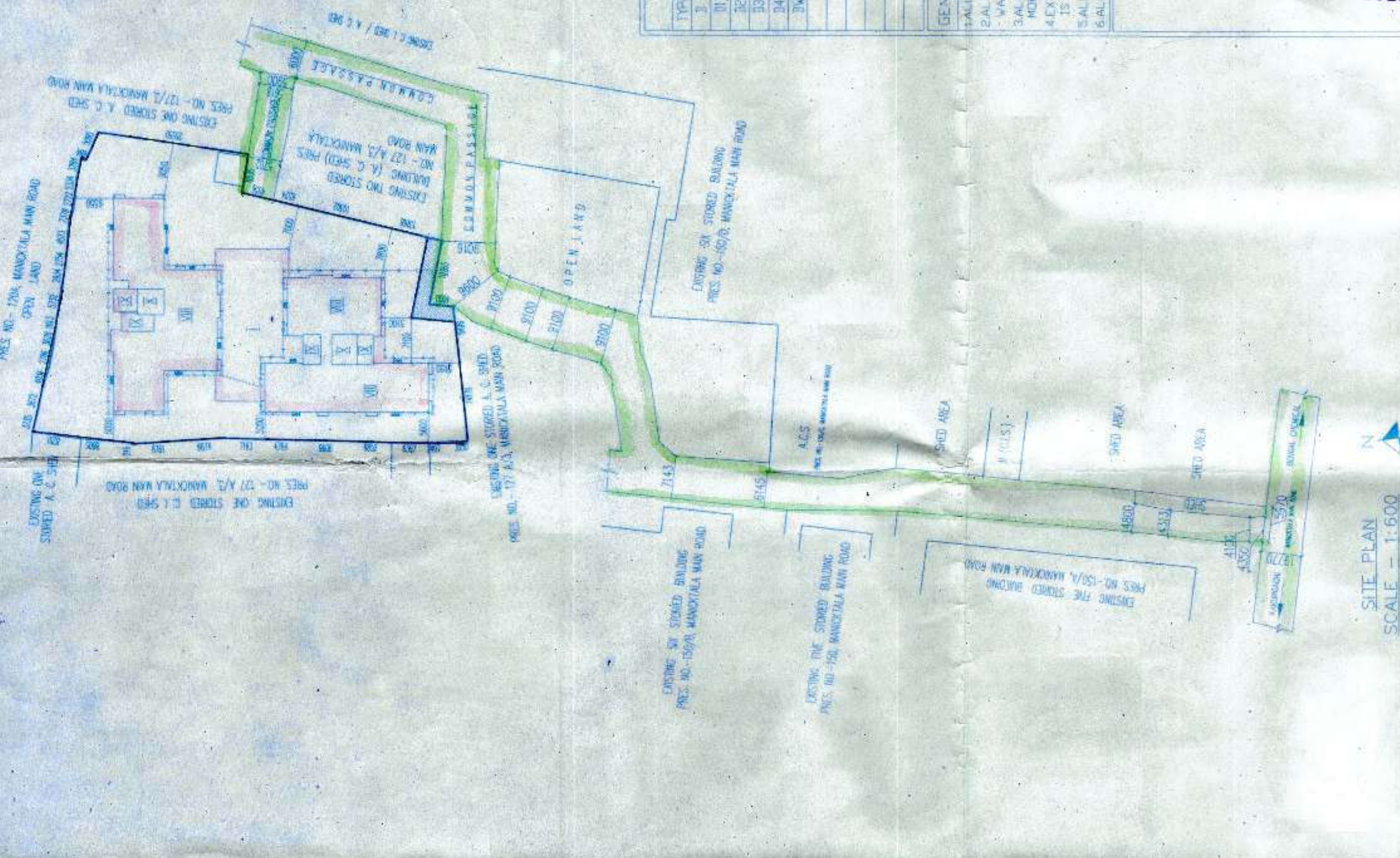

SITE PLAN
SCALE = 1:500

PIPE SCHEDULE	SIZE	TYPE	SCHEDULE	REMARKS
1	200	BRICKWORK	VI	200 x 200
2	200	BRICKWORK	VII	200 x 200
3	200	BRICKWORK	VIII	200 x 200
4	200	BRICKWORK	IX	200 x 200
5	200	BRICKWORK	X	200 x 200
6	200	BRICKWORK	XI	200 x 200
7	200	BRICKWORK	XII	200 x 200
8	200	BRICKWORK	XIII	200 x 200
9	200	BRICKWORK	XIV	200 x 200
10	200	BRICKWORK	XV	200 x 200
11	200	BRICKWORK	XVI	200 x 200
12	200	BRICKWORK	XVII	200 x 200
13	200	BRICKWORK	XVIII	200 x 200
14	200	BRICKWORK	XIX	200 x 200
15	200	BRICKWORK	XX	200 x 200
16	200	BRICKWORK	XXI	200 x 200
17	200	BRICKWORK	XXII	200 x 200
18	200	BRICKWORK	XXIII	200 x 200
19	200	BRICKWORK	XXIV	200 x 200
20	200	BRICKWORK	XXV	200 x 200

GENERAL NOTES

- ALL DIMENSIONS ARE IN METERS.
- ALL EXTERNAL WALLS FOR THE EXISTING BUILDING SHALL BE CONSIDERED AS 200mm THICK.
- ALL EXTERNAL WALLS FOR THE NEW BUILDING SHALL BE CONSIDERED AS 200mm THICK.
- ALL EXTERNAL WALLS FOR THE NEW BUILDING SHALL BE CONSIDERED AS 200mm THICK.
- ALL EXTERNAL WALLS FOR THE NEW BUILDING SHALL BE CONSIDERED AS 200mm THICK.
- ALL EXTERNAL WALLS FOR THE NEW BUILDING SHALL BE CONSIDERED AS 200mm THICK.
- ALL EXTERNAL WALLS FOR THE NEW BUILDING SHALL BE CONSIDERED AS 200mm THICK.
- ALL EXTERNAL WALLS FOR THE NEW BUILDING SHALL BE CONSIDERED AS 200mm THICK.
- ALL EXTERNAL WALLS FOR THE NEW BUILDING SHALL BE CONSIDERED AS 200mm THICK.
- ALL EXTERNAL WALLS FOR THE NEW BUILDING SHALL BE CONSIDERED AS 200mm THICK.

CERTIFICATE OF STRUCTURAL ENGINEER

I, the undersigned, being a duly qualified Structural Engineer, have examined the drawings and specifications for the proposed building and have found that the same conform to the requirements of the National Building Code of India and that the building is safe and stable in all respects.

SANJAY P. PARIKH
REGISTERED STRUCTURAL ENGINEER
No. 12345
Mumbai
Signature: _____
Date: _____

CERTIFICATE OF ARCHITECT

I, the undersigned, being a duly qualified Architect, have examined the drawings and specifications for the proposed building and have found that the same conform to the requirements of the National Building Code of India and that the building is safe and stable in all respects.

Raj Kumar Agarwal
REGISTERED ARCHITECT
No. 67890
Mumbai
Signature: _____
Date: _____

PROJECT

PROPOSED 4-FLY (25.4 MT) STORED RESIDENTIAL BUILDING AT PREMISES NO. 127/3/1, MANDAITALA MAIN ROAD, MANDAITALA, PS-MANDAITALA, WARD NO. 32, BOROUGH-11.

DATE 12/08/11
SCALE AS SHOWN
PROJECT NO. 123456789
SHEET NO. 1 OF 2
PREPARED BY ARCHITECT
CHECKED BY ARCHITECT
DATE 12/08/11
SCALE AS SHOWN

RAJ K. AGARWAL & ASSOCIATES
ARCHITECTS
B-10, JAY PATEL STREET, LAKHTIA, B-11, B-12, B-13, B-14, B-15, B-16, B-17, B-18, B-19, B-20, B-21, B-22, B-23, B-24, B-25, B-26, B-27, B-28, B-29, B-30, B-31, B-32, B-33, B-34, B-35, B-36, B-37, B-38, B-39, B-40, B-41, B-42, B-43, B-44, B-45, B-46, B-47, B-48, B-49, B-50, B-51, B-52, B-53, B-54, B-55, B-56, B-57, B-58, B-59, B-60, B-61, B-62, B-63, B-64, B-65, B-66, B-67, B-68, B-69, B-70, B-71, B-72, B-73, B-74, B-75, B-76, B-77, B-78, B-79, B-80, B-81, B-82, B-83, B-84, B-85, B-86, B-87, B-88, B-89, B-90, B-91, B-92, B-93, B-94, B-95, B-96, B-97, B-98, B-99, B-100